

TOTAL EXTENT (AS PER PATTA) : 1735 SQ.M ✓
 ROAD AREA : 676 SQ.M ✓
 NO.OF.PLOTS : 11Nos. ✓

NOTE:



1. SPLAY - 1.5M X 1.5M
2. MEASUREMENTS ARE INDICATED EXCLUDING SPLAY DIMENSION.
3. ROAD AREA WAS HANDED OVER TO THE LOCAL BODY
 VIDE GIFTDEED DOCUMENT NO: 4326/2019, DATED 17.06.2019 @ SRO PADAPPAI

CONDITION :

DR RULE NO : 29 (11)

THE COST OF LAYING IMPROVEMENTS TO THE SYSTEMS IN RESPECT OF ROAD, WATER SUPPLY, SEWERAGE, DRAINAGE OR ELECTRIC POWER SUPPLY THAT MAY BE REQUIRED AS ASSESSED BY THE COMPETENT AUTHORITY SHALL BE BORNE BY THE APPLICANT.

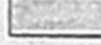
LEGEND :

-  SITE BOUNDARY ✓
-  ROADS GIFTED TO LOCAL BODY ✓
-  EXISTING ROAD ✓

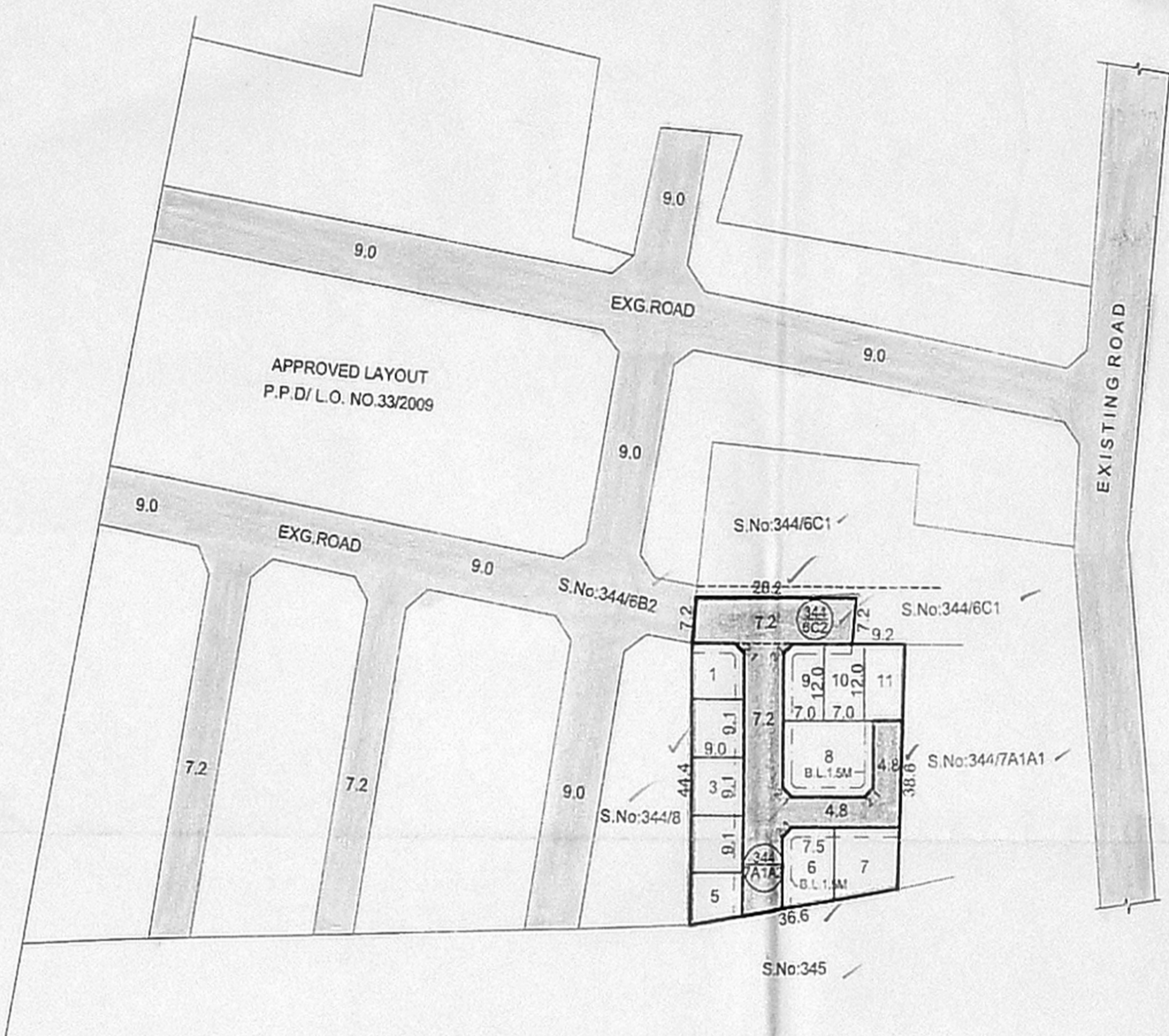

CONDITION:-
 THE LAYOUT APPROVAL IS VALID SUBJECT TO OBTAINING SANCTION FROM THE LOCAL BODY CONCERNED

P.P.D NO 73
 L.O 2019
 APPROVED
 VIDE LETTER NO : L1/18589/2018
 DATED : 07/2019

[Signature]
 FOR SENIOR PLANNER(M.S.B/LAYOUT)
 CHENNAI METROPOLITAN
 DEVELOPMENT AUTHORITY

[Signature]
 31/7/19
 PREPARED BY

[Signature]
 03/07/19
 P.A.II

[Signature]
 03/07/2019
 A.P

KUNDRATHUR PANCHAYAT UNION

LAY OUT OF HOUSE SITES IN S.Nos:344/6C2 AND S.No.344/7A1A2 OF NADUVEERAPATTU VILLAGE.

SCALE-1:800 (ALL MEASUREMENTS ARE IN METRE)

